



Art No. WC0019

Outdoor IP Dome Camera with 22x PTZ, H.264

Feature:

- 1/3" H.R. CCD image sensor
- Resolution: NTSC: 768 (H) x 494 (V) ; PAL: 752 (H) x 582 (V)
- Advanced Auto Tracking Accuracy - to follow the moving object
- MPEG4, MJPEG and H.264 compression
- Supports 360 degree pan and 90 degree tilt, continuous rotation
- 22x Zoom F1.6 (wide) ~ F3.7(Tele), view: 60°~4°
- Flexible Color / Shutter Parameters Adjustment - to adapt various light conditions
- Outdoor IP Rating with IP66
- Motion detection and alarm notification via Email
- Supports 3G Mobile Phone Surveillance (iPhone, BlackBerry, WinCE, J2ME & Android, Symbian Support)
- Supports multiple access levels with password
- Supports Auto Tracking
- Supports up to 10 users on-line
- Complete IP surveillance system with Central Management System (CMS) software for up to 16 cameras at the same time

Specification:

• Environment	
In/Out door use	Outdoor
Day/Night	Yes
• Network	
Network Compression	H.264 / MPEG4 / MJPEG
LAN Port	YES
LAN Speed	10/100 Based-T Ethernet
Supported Protocols	DDNS, PPPoE, DHCP, NTP, SNTP, TCP/IP, ICMP, SMTP, FTP, HTTP, RTP, RTSP
Frame Rate	NTSC: 30, PAL: 25
Number of Online Users	10
Security	Multiple user access levels with password protection

* The specifications and pictures are subject to change without notice.
*All trade names referenced are the registered namework of their respective owners.





Art No. WC0019

Outdoor IP Dome Camera with 22x PTZ, H.264

Specification:

Web Management	(1) Web browsers, such as Internet Explorer, Mozilla FireFox & Google Chrome for single device access, or (2) Free CMS software, Video Viewer, for up to 16 network cameras control simultaneously
• Camera	
Image Sensor	1/4" Sony Color Super HAD CCD
Pixels	768(H) x 494(V) <NTSC> / 752(H) x 582(V) <PAL>
Resolution	High Resolution
Lens	f3.9 ~ 85.9mm
F-number	F1.6 (Wide) ~ 3.7 (Tele)
Viewing Angle	4° ~ 60°
Pan Range	360°
Tilt Range	90°
Max. Pan / Tilt Speed	Pan 360°/s, Tilt 90°/s
Zoom	22X Optical Zoom
Max. Zoom Speed	Approx. 7s (Tele ~ Wide)
Shutter Speed	1 / 60 (1/50) to 1 / 100,000 sec.
Min. Illumination	0.3 Lux / F1.6
BLC	On / Off
Color Adjustment	Brightness, Contrast, Saturation and Hue
Preset Points	Up to 16 preset points can be set
Sequence Groups	1. Up to four groups can be set 2. One group can include up to 16 preset points
S/N Ratio	More than 48dB (AGC off)
White Balance	Auto / Indoor 1 / Indoor 2 / Sun / Cloudy * Indoor 1 = 9000K; Indoor 2 = 3000K; Sun = 5500K; Cloudy = 7000K
IP Rating	IP66

* The specifications and pictures are subject to change without notice.
*All trade names referenced are the registered namework of their respective owners.





Art No. WC0019

Outdoor IP Dome Camera with 22x PTZ, H.264

Specification:

Power Source ($\pm 10\%$)	DC12V, 3.3A (Max)
Operating Temperature	-10°C ~ 50°C (14°F ~ 122°F) / Fan: 40°C on, 30°C off
Humidity	85%
Dimensions (mm)**	323(W) x 339(H) (bracket included)
• Others	
Mobile Surveillance	iPhone, BlackBerry, Windows Mobile & Symbian
Motion Detection	YES
Alarm and event Notification	By FTP and Email
Shutter Speed	1 / 60 (1/50) to 1 / 100,000 sec.
Minimum Web Browsing Requirements	- Pentium 4 CPU 1.3 GHz or higher, or equivalent AMD - 256 MB RAM - AGP graphics card, Direct Draw, 32MB RAM - Windows 7, Vista, XP, Windows 2000 Server, ME, 98, DirectX 9.0 or later - Internet Explorer 6.x or later

Package Contents

- 1 x Outdoor IP Dome Camera
 - 1 x CD-ROM disc for user manual
 - 1 x Bracket
- Optional: WC0019A Power Adapter DC12 3.3A

Packaging Information:

- Packing Dimension: 210x208x264 mm
- Packing Weight: 1.74kgs
- Carton Dimension: 440x110x560 mm
- Carton Q'ty: 8pcs
- Carton Weight: 13.98kgs

Bracket for WC0019

- Carton Dimension: 130x280x370 mm
- Carton Q'ty: 2pcs
- Carton Weight: 10.6kgs

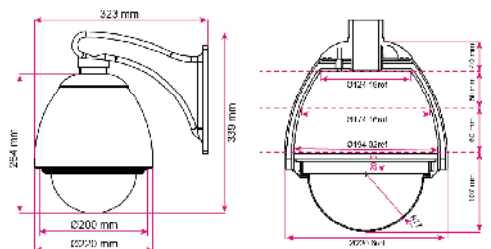

* The specifications are subject to change without notice.

** Dimensional tolerance: (± 5 mm)

* The specifications and pictures are subject to change without notice.
** All trade names referenced are the registered trademark of their respective owners.

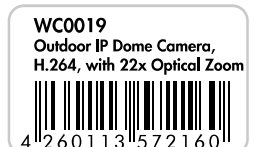

Made in Taiwan